

Instructions for Use

DKL E1 Work Stool

Manufacturer:
DKL GmbH
An der Ziegelei 4
D-37124 Rosdorf
Germany
(+49) 0551-50060
info@dkl.de
www.neuepolster.de



TABLE OF CONTENTS

| | |
|--------------------------------------|---|
| 1. General Information | 2 |
| 1.1. Introduction | 2 |
| 1.2. Symbols Used | 2 |
| 1.3. Safety Instructions | 2 |
| 2. Technical Data | 3 |
| 3. Assembly Instructions | 3 |
| 4. Operating Instructions | 4 |
| 5. Maintenance Instructions | 5 |
| 5.1. Cleaning, Disinfection and Care | 5 |
| 5.2. Technical Maintenance | 5 |
| 6. Disposal Instructions | 5 |

1. General Information

1.1. Introduction

We are pleased that you have chosen a DKL GmbH work stool. These instructions for use are intended to provide you with all the important information for using this stool.

This DKL Work Stool is designed as a seating solution. It is intended to provide an ergonomic and comfortable sitting position.

IMPORTANT! Please keep the instructions for use within reach. If the instructions cannot be found, we will be happy to assist you. Please provide us with the model designation, which can be found on the type plate under the seat cushion.



We are at your disposal for any questions regarding the product received.

DKL GmbH, An der Ziegelei 4, D-37124 Rosdorf, Germany
Mon. – Thu. from 8 a.m. to 5 p.m.: Tel. +49 551 / 5006 202

Email polster@dkl.de

1.2. Symbols Used



WARNING! Risk of personal injury.



WARNING! Risk of property damage.



Observe printed or electronic instructions for use.



Disposal instructions / Recycling.

1.3. Safety Instructions



- **WARNING!** To avoid personal injury and property damage, observe all safety instructions in the following manual before using the stool for the first time.
- Use the work stool only as a seating furniture.
- Compliance with national and local regulations and safety provisions is the responsibility of the user; in particular, applicable occupational health and safety regulations and accident prevention measures must be observed.
- Observe the maximum permissible load capacity of 130 kg for the work stool.
- Always ensure the stool can roll barrier-free and avoid rolling over lines or cables to prevent the risk of falling due to tipping and to avoid property damage.
- Check the stool for visible, safety-related damage or malfunctions before each use. If there are defects that could endanger operational safety, the stool must not be used.
- In the event of damage or malfunctions, contact trained specialist personnel or our customer service.
- **WARNING!** Risk of injury from high pressure! Never attempt to open or repair a gas pressure spring.
- Only original DKL spare parts may be used for repairs.
- Carry out the recommended inspection and maintenance work regularly.
- To ensure operational readiness, check the stool at least once a year for damage, malfunctions, tight fit of screw connections, wear, and corrosion.
- Do not use or store the stool outdoors and protect it from moisture.
- Observe the instructions for cleaning, disinfection, and care in this manual.

2. Technical Data

The DKL E1 work stool is offered in a high version (DKLE1H) and a lower version (DKLE1T).

| High Version DKLE1H | |
|---|----------|
| Seat height from floor, lowest position (unloaded) | 560 mm |
| Seat height from floor, highest position (unloaded) | 740 mm |
| Seat width | Ø 400 mm |
| Net weight | 8.6 kg |
| Maximum permissible load | 130 kg |
| 5-arm base | Ø 600 mm |

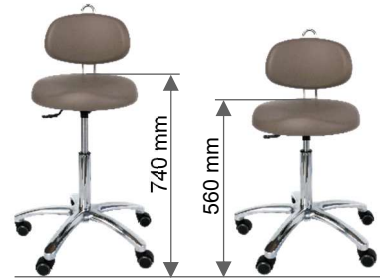

| Lower Version DKLE1T | |
|---|----------|
| Seat height from floor, lowest position (unloaded) | 480 mm |
| Seat height from floor, highest position (unloaded) | 600 mm |
| Seat width | Ø 400 mm |
| Net weight | 8.3 kg |
| Maximum permissible load | 130 kg |
| 5-arm base | Ø 600 mm |

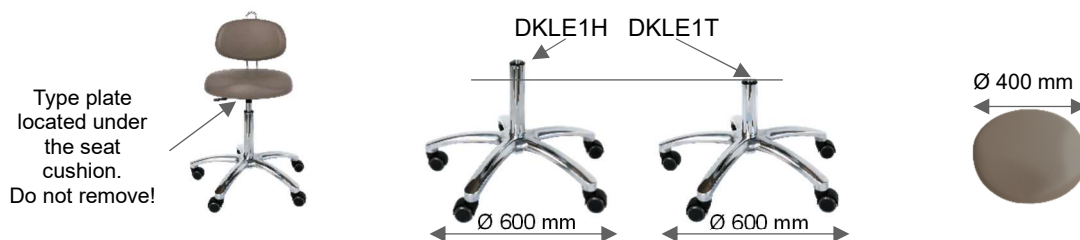

3. Assembly Instructions

The assembly instructions for DKL E1 work stools are identical for the high version (DKLE1H) and the lower version (DKLE1T).

CAUTION! When unpacking the components, make sure not to damage them with cuts, etc.

Assembly is straightforward and tool-free.
The DKL E1 work stool consists of three components that are plugged into each other.



- 1) Place the base **1** on the floor.
- 2) Position the gas pressure spring **2** with the wider end into the central opening of the base.
- 3) Pull off the protective cap at the upper end of the gas pressure spring.
- 4) Position the cushion **3** of the work stool with the central opening under the seat cushion onto the upper end of the gas pressure spring.
- 5) Press the cushion down firmly and sit on the work stool. Apply your full body weight to the seat several times in a row so that the gas pressure spring is firmly seated in the mount and does not come loose when the stool is lifted.
- 6) Check all adjustment functions in the following chapter of the operating instructions.

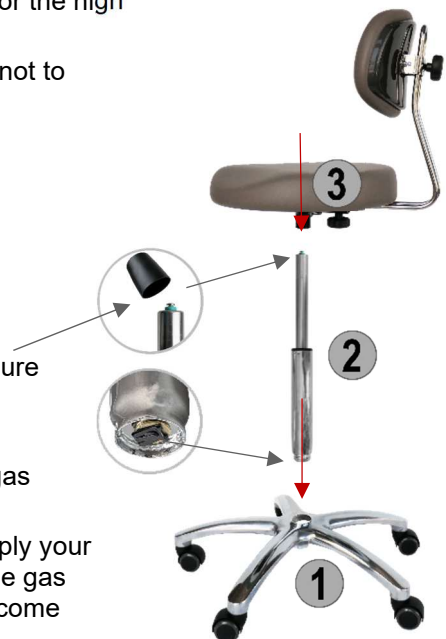

4. Operating Instructions

The operating instructions for DKL E1 work stools are identical for the high version (DKLE1H) and the lower version (DKLE1T).

The DKL E1 work stool was developed to combine the highest ergonomic standards with maximum safety. Every detail serves your comfort:

- **Ergonomic seat:** The specially shaped seat with integrated recesses for the legs offers you optimal support and relieves the thighs.
- **Ergonomic backrest:** The shape of the height-adjustable backrest actively supports your lumbar region and ensures a pleasant sitting sensation.
- **Infinitely variable height adjustment with depth suspension:** Thanks to the high-quality gas pressure column (Class 4), you can adjust the seat height and the height of the backrest infinitely. The integrated comfort depth suspension gently cushions the body weight when sitting down through a slight lowering and thus protects your spine.
- **Safety casters:** The low-noise double casters are equipped with a load-dependent brake that prevents unintentional rolling away when standing up. The smooth-running PU tread of the universal caster is suitable for all hard floor coverings and low-pile carpets.
- **Stable aluminium base:** The 5-arm aluminium base guarantees high stability and optimal freedom of movement.
- **Symmetrical design:** The chair features a completely symmetrical construction, allowing it to be oriented in any direction without restriction.

For an ergonomically optimal sitting position, two adjustment options are offered:

Height adjustment of the seat surface

The infinite height adjustment is performed by lifting the adjustment lever under the seat. If the seat is loaded by body weight, the seat lowers. If the seat is unloaded, it rises. When the lever is released, the set seat height is fixed.

Height adjustment of the back cushion

The infinite height adjustment is performed via the rotary screw behind the back cushion. Loosen the rotary screw and raise or lower the cushion to an ergonomically optimal position. Finally, tighten the rotary screw again.

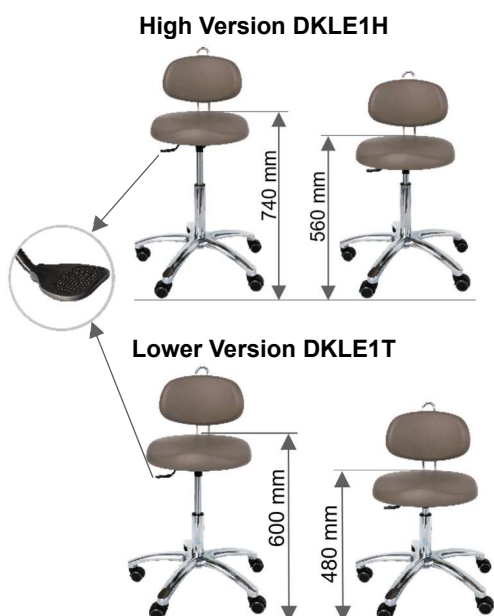

5. Maintenance Instructions

5.1. Cleaning, Disinfection and Care

- **Cleaning and care of dental upholstery:** As a specialist for dental upholstery of all brands, DKL GmbH has an extensive range of cleaning and care products tailored to the needs of dental synthetic leather surfaces. You can find our range with helpful application videos at <https://neupolster.de/en/Cleaning-care-disinfection/>.
- **Cleaning other surfaces:** Use DentaClean from our range to clean metal and plastic surfaces. Do not use cleaning agents with an abrasive effect or chlorine or alcohol cleaners.
- **Surface disinfection:** Use an alcohol-free wipe disinfection suitable for plastic surfaces. Plastics, synthetic leather, and metal surfaces of the DKL work stool can be disinfected with this wipe disinfection.

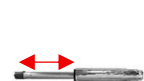
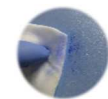

CAUTION! Substances used in the work environment can cause permanent stains on surfaces. Therefore, always remove visible contamination and stains immediately.



IMPORTANT! Check the casters for dirt on the treads and axles and clean them as needed.



ATTENTION! Do not clean the piston of the gas pressure spring unnecessarily (lubricating film). In case of contamination (dust/grease), wipe the extended piston dry. Use cleaning spray (e.g. WD-40) only in cases of heavy sticking. Important: Afterwards, always apply a very thin layer of resin-free multi-purpose grease or silicone spray and operate the height adjustment several times to distribute it.

5.2. Technical Maintenance



- Check the stool for visible, safety-related damage or malfunctions before each use. If there are defects that could endanger operational safety, the stool must not be used.



- Depending on the intensity of use, but at least once a year, check the stool thoroughly for safety-related damage or have this check carried out by trained specialist personnel.

Inspection components:

- Check the stool for visible damage, wear, and corrosion that could endanger safety during use.
- Check the function of the gas pressure spring and the smooth running and secure fit of the casters.
- Check the tight fit of all visible screw connections.
- Check the narrow piston for contamination (sticky film of dust/grease). This can impair the height adjustment. For cleaning and care, see point 5.1.
- In the event of a necessary repair, contact our customer service or trained specialist personnel.

6. Disposal Instructions

PACKAGING



The packaging consists of recyclable materials. Please dispose of it via the separate material recovery collection in accordance with local regulations.

WORK STOOL



At the end of its service life, the stool must not be disposed of in the household waste. Since it consists largely of metal, it should be sent to a certified metal recycler or recycling centre.



WARNING! The gas pressure spring is under high pressure. Improper disassembly or forced opening during disposal can lead to serious injuries. Therefore, leave the disposal of the stool to specialist companies or inform the disposal company about the installed gas pressure spring.